

## HB 604 TIMBER FIXING KIT

The HB 604 allows various Halliday + Baillie flush pulls to be installed into timber joinery with concealed fixing.

Most of our flush pull handle range are designed to go straight into aluminium or steel joinery without the use of these kits.

For each flush pull you require 1 x HB 604 Timber Fixing Kit. All flush pulls ship with the timber fixing kit.

Flush Pulls using HB 604:

HB 650  
HB 660  
HB 660/35  
HB 665  
HB 668  
HB 670  
HB 675  
HB 677  
HB 678  
HB 679  
HB 3370  
HB 3375

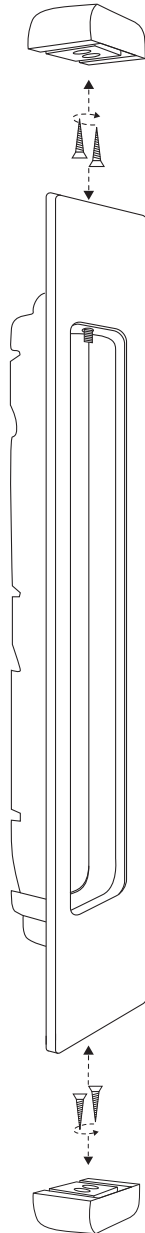

Screw fixing kits shown for timber

HB 604 Timber Fixing Kit on timber doors

