



CORE RANGE



2021
CORE RANGE

“Halliday + Baillie offers Architects and Designers products of the highest integrity for both residential and commercial applications. Our range of architectural hardware is 100% designed and manufactured in New Zealand and supplied to discerning customers around the world who demand distinctive quality. We are continually striving to create classic hardware that will stand the test of time.” MARCUS HALLIDAY

This condensed 'look book' provides a glimpse of our most popular items. This includes flush pulls, lock and snib sets, D Handles and accessories, that have been tested and enjoyed in architectural projects over the past two decades. They make up the backbone of the Halliday + Baillie range, and are the inspiration for much of the rest of our extended collection of hardware.

All our products are proudly designed and fabricated in New Zealand and there is further information on our fabrication partners and manufacturing processes throughout this book. Information in this catalogue is effective from July 2020 and makes up part of the overall Halliday + Baillie product set (please see our latest Product List online).

General Terms and Conditions of Sale and Product Liability are available in writing upon request or can be downloaded from www.hallidaybaillie.com. Please understand that despite our best possible care, no responsibility is taken for any printing errors or omissions. Any reprint, even in excerpts, is strictly subject to prior approval.



MADE BY HAND

As an island nation, New Zealand's natural beauty can be unusually harsh, and have a corrosive effect on construction materials such as door hardware. All our products are tried and tested in these conditions to look great and deliver outstanding, long life performance. With 13 standard colours in the range, you can choose a finish that will compliment your project.

The durability of any hardware depends on what it is made of and the finishes and coatings applied. All Halliday + Baillie products are designed and manufactured in New Zealand from the highest quality materials with traceable provenance. Our zinc, solid brass, solid bronze, aluminum, and 316 marine grade stainless steel are certified quality, from accredited producers.

To further bring our products to life, our ISA13485, ISO14001, and ISO9001 rated Engineers are experts in precision componentry fabrication for some of the world's leading brands.

For our electroplated finishes, hardware is plated to withstand even the most unforgiving environments. While hardware can be used with a thickness as low as 10 microns, all our electroplated products are finished to the highest New Zealand "Sea Spray Zone" rating of 25 microns thickness (NZ Anodising Standard). Even if your project is not on the beach, you have the peace of mind of knowing your hardware can withstand years of exposure.

Our powder coaters – operating the latest fully automatic powder coating plant – are specialists in the new Dulux Electro™ range of coatings. With no liquid chemicals, solvents, or caustic solutions used in their manufacturing process, Electro™ coatings have negligible VOC content so not only look great, but are leaders of the field with their durability, UV stability, and eco-credentials.

Be it a sliding door, stair way, or grand entry, we have created classic hardware to work with your next project.

Working with innovative, certified, and experienced manufacturing partners, using materials with traceable provenance, to make classic hardware with care.



Flush Pulls – not just a functional fitting but a chance to add drama and elegance to doors and cabinetry.



THE EXTENDED FAMILY OF FLUSH PULLS:

Welcome to the Family! At Halliday + Baillie we understand that not all doors are created equal so we have curated a wide collection of flush pulls that cater to everything from small sliding windows, to grand pivot doors.

Whilst one size most definitely won't fit all, we also know that the majority of doors are well served by only a few standard options. Covering sizes from 105mm through to the larger 250mm size the HB650, HB660, HB665, and HB668 suit a wide range of sliding doors. Over the years, these few flush pulls have become the stalwarts of the Halliday + Baillie range.

All flush, and bi-fold/pivot grip pulls 250mm or less are diecast in batches, then coloured to one of wide range of standard Halliday + Baillie finishes.

While equally at home on sliders, the HB675 and HB677 pulls are specifically designed with a larger internal offset grip ideal for swing and pivot doors.

End Pulls are available to compliment flush pulls to cavity pocket doors that fully retract into the wall. The HB680 End Pull is also diecast, with an integrated spring-loaded handle activated by a quick touch of the 'pop-out' button.

Too big to fit the page!
While smaller sizes are usually enough our largest flush pull is over half a metre tall.



HB 1575

Flush hardware is not just for sliding doors. Our favourites are great on sliders, but with extended grip options available, flush hardware can also be used on hinge, pivot, and bi-folding doors.



FLUSH PULLS & EDGE PULLS

MODEL	DESCRIPTION	GRIP	FINISH
HB 660	Flush Pull, 36mm x 170mm	Sliding	All Finishes
HB 660/35	Shallower version of the HB 660 Flush Pull for 35-38mm doors	Sliding	All Finishes
HB 665	Flush Pull, 36mm x 250mm with full length recess	Sliding	All Finishes
HB 668	Flush Pull, 36mm x 250mm with recess to match Flush Pulls on HB 630 & HB 640 sets	Sliding	All Finishes
HB 675	Offset Grip Flush Pull, 46mm x 170mm handed for right and left hand use	Offset	All Finishes
HB 677	Offset Grip Flush Pull, 46mm x 250mm handed for right and left hand use	Offset	All Finishes
HB 604	Timber Fixing Kit for Flush Pulls, 105mm - 250mm	NA	NA
HB 680	Button-Activated Edge Pull, No Grip, 20mm x 170mm	Offset	All Finishes

■ All Flush Pulls require the appropriate Timber Fixing Kit for installation in timber doors. All the flush pulls above require the HB604. HB1410, and HB1510 Fixing Kits are also available for some of our largest sizes.

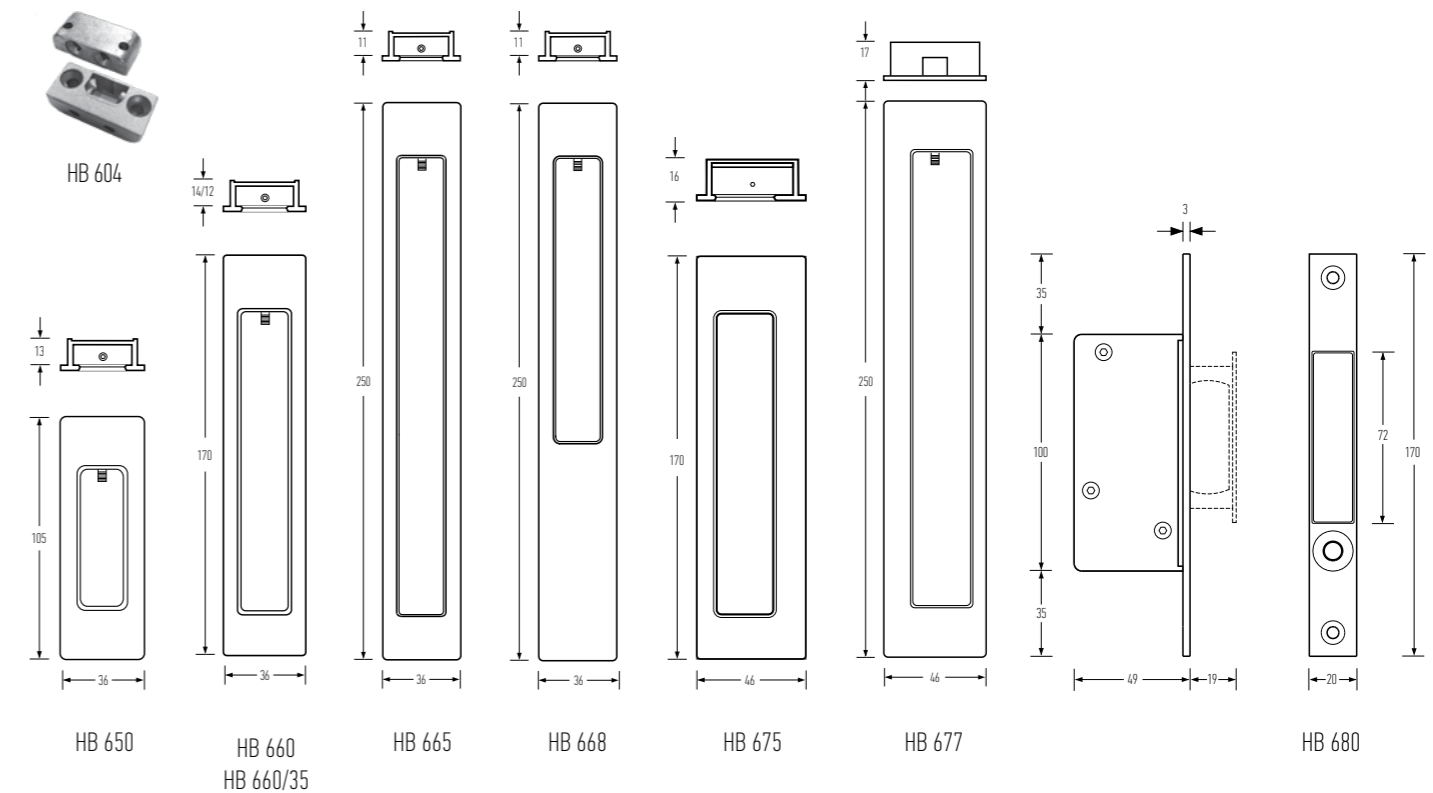

The flush pulls above are great for most applications, with the extended range below covering other more specialised requirements.

Designed and manufactured in New Zealand

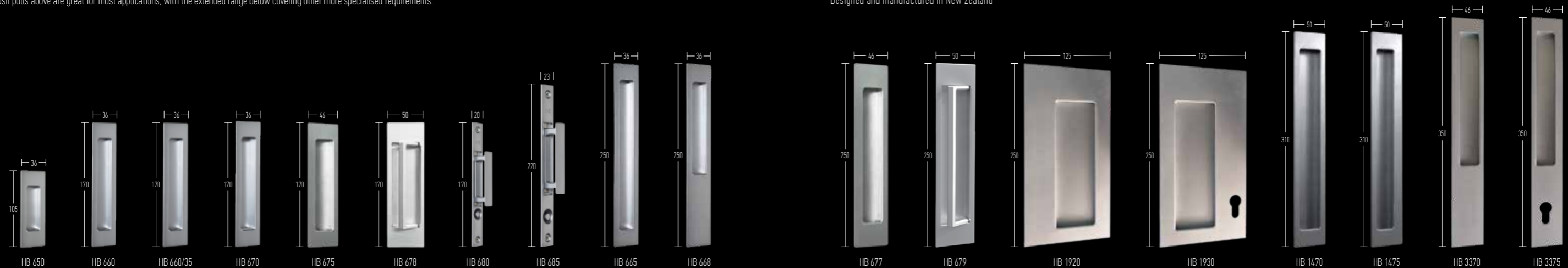



MAKING IT SEAMLESS

Passage doors are not the whole story...

To complement the 170mm, 250mm, and even the larger 310mm flush pulls there is a comprehensive range of privacy, snib and lock sets for entry, security, and privacy needs.

The HB 690 privacy set - developed over a decade ago to provide a slim line non-turning solution for washroom cavity slider doors - has been the trail blazer for all the Halliday + Baillie sets.

Over time this simple solution has grown into a range of more than 50 lock body and set variations. Sets encompass the classic privacy option, where an emergency release flush pull is provided for ease of access no matter what the situation, to double sided key locking sets for external sliders.

Using the same aesthetic and high end mortice locks, Halliday + Baillie also provide a range of options for pivot doors, bi-folds, and swing doors.

With this many options, projects can have a cohesive look from front door to back.

No matter the door type or size our range of over 50 privacy, snib, and lock sets has you covered

KEEPING THINGS PRIVATE

HB690 PRIVACY SET

What started as an elegant way to provide discrete privacy locking for bathrooms and washrooms has ended up as the basis for almost 40 different functions and configurations.

The classic HB690 Privacy Set has a one motion, no turn, privacy lock activated with a quick slide of the integrated snib. It works in a minimum 38mm door, and with a quick swap of flush pulls can also work as a latch set, or as a simple non-key lock set.

If your doors are slimmer, then the HB690-35 caters to doors from 35mm to 38mm+ with no compromise on the internal finger depth.

HB690 SERIES

Understanding the various combinations available depends on two things – the type of flush pull handle used, and the type of internal lock body. All sets shown below utilise the same size lock body, but give different functions depending on the handles and the bolt.

FLUSH PULLS

The HB690 Privacy set itself uses the 170mm HB660 flush pulls with a standard sliding grip. Flush pulls of 250mm, and 310mm can also be used to create even more options, including those with the extended bi-fold/pivot grip, perfect for a sleek flush solution for hinge doors.



HB690 Standard

The classic, with “parrot beak” claw sliding bolt, and integrated end pull. Perfect for sliding pocket doors.



HB690D Deadbolt

A traditional locking bolt, this body works on hinge, bi-fold, or pivot doors when used with an extended grip flush pull.



HB691 No Pop Out

Still with the sliding claw bolt, with no pop out. Great if you have a slider that doesn't retract into a wall pocket or cavity.



HB697

Not really a lock body, but vital if you want everything in your door ends to match perfectly. This body has the same dimensions as the HB690 but with no bolt included enabling it to act as a strike plate on bi-parting doors where a perfect match and pop outs to both sides are required.

With a fully enclosed case and components of cast alloy, milled solid brass, and laser cut stainless steel, the HB 690 Body comes in four variants for maximum flexibility

The HB 690 Series comes in all the standard Halliday + Baillie finishes, and the adaptable locking mechanism works with numerous versions below.

Designed and manufactured in New Zealand



HB 690 Series



HB 695 Series



HB 1480 Series



HB 1490 Series



HB 1650 Series



HB 1480D Series



HB 1650D Series



Dustbox & strike plate
110mm x 25mm x 2mm



HB 604 timber fixing kit
for installation of flush pulls



HB 641
Adjustable strike
120mm x 20mm
variable depth 18-25mm



HB 690 SERIES PRIVACY/SNIB LOCKS 55mm BACKSET + END PULL

Please note that the "HB 690 Series" denotes the type of lock body used with various flush pull configurations. The sets below are SNIB ONLY. For key locking versions please see the upcoming section on lock sets.

MODEL	DESCRIPTION	FINISH
HB 690	Privacy Set 170mm Pulls	All Finishes
HB 690/35	Privacy Set 170mm Pulls, for 35mm thick doors	All Finishes
HB 692	Snib Inside, Blank Outside, 170mm Pulls	All Finishes
HB 693	Snib Inside, No Pull Outside, 170mm Pulls	All Finishes
HB 694	Snib Both Sides, 170mm Pulls	All Finishes

HB 691	Body Only no End Pull	All Finishes
HB 697	Body + End Pull, no Bolt (replaces strike on bi-parting doors)	All Finishes

- Please note that the 'HB690 Series' denotes the type of lock body used with various flush pull configurations. The sets below are SNIB ONLY. For other options please see the main H+B catalogue.
- DOOR THICKNESS STANDARD HB 690 and HB 690/35 SERIES:** For standard HB 690 configurations minimum door thickness is 38mm. For HB 690/35 configurations minimum door thickness is 35mm (these sets will not function in less than 35mm doors).
- Sliding Door Sets are shipped with strike plate, dust box and fixings.
- Rebate kits for both French Door and Bull Nose profiles are also available on request.
- HB 691 and HB 697 require standard Flush Pulls purchased separately to match the locking door leaf.

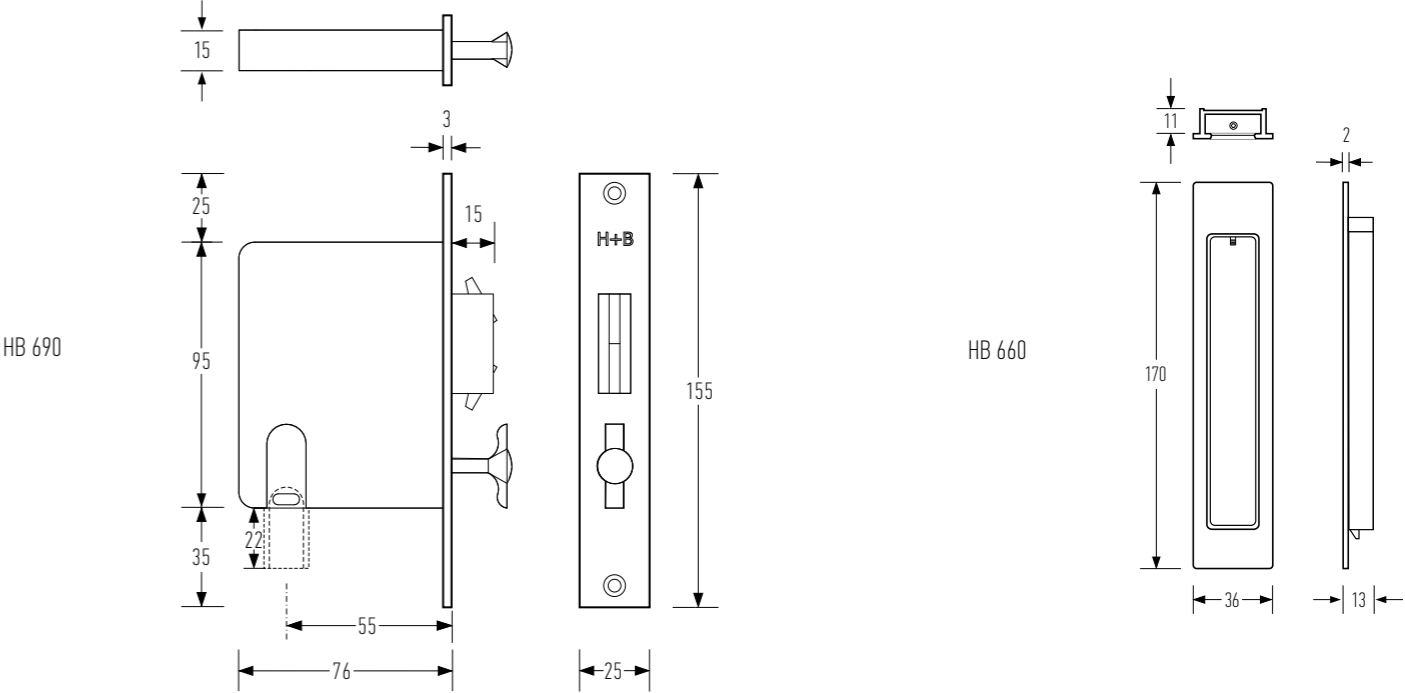

Designed and manufactured in New Zealand



HB 690 & HB 690/35



HB 692 & HB 692/35



HB 693 & HB 693/35



HB 694 & HB 694/35





MANAGING SECURITY

With sliding doors an increasingly popular option for exterior openings, the range would not be complete without key locking options.

Our 250mm sets come in two backset variants for use with both aluminum and timber joinery. Over the years the HB 640 Series (primarily used with aluminum joinery profiles, but also useful on narrow timber stiles, and hybrid timber/aluminum sets) has become the go-to for exterior locking.

If locking with a key is not required but security is still paramount there are a number of options utilising a snib flush pull on one side of the door only. Alternatively installing one of the Halliday + Baillie standalone mortice locks allows the use of proprietary or custom pull handles.

All sets are made with high quality brass, stainless steel and cast componentry, fit a standard Euro cylinder, and are available in all of the Halliday + Baillie finishes.

A range of lock sets and stand alone mortices providing keyed security solutions for all door types

Our most popular locking set is the HB 642 providing the function of a deadbolt with the ease of snib sliding



HB 640 SERIES KEYED LOCKS NARROW 33mm BACKSET

■ Please note that the "HB 640 Series" denotes the type of lock body used with various flush pull configurations. The HB 640 set with snib and key both sides is one possible configuration in the series. In all H+B Sliding Lock Sets the key and snib work independently of each other, where the snib throws the bolt, and the key locks the bolt in place. On models with a key and snib both sides, sliding the snib will only 'latch' the door (similar to a standard door handle), and a key is needed to make the door secure.

■ Please note that only EBA, EDB, EMB, PB, PC, SC, WHT finishes are available in the Australian market.

MODEL	DESCRIPTION	FINISH
HB 640	Key/Snib Both Sides	All Finishes
HB 642	Key/Snib Inside, Blank Outside	All Finishes
HB 643	Key/Snib Inside, No Pull Outside	All Finishes

HB CLF 4021	3 Pin ½ Euro Cylinder for 38mm door	SC, others by order
HB CLF 4020	3 Pin DBL Euro Cylinder for 38mm door, keyed both sides	SC, others by order
HB CLF 48 S	3 Pin ½ Euro Cylinder for 45mm door	SC, others by order
HB CLF 48 D	3 Pin DBL Euro Cylinder for 45mm door, keyed both sides	SC, others by order

■ DOOR THICKNESS: minimum thickness for all configurations is 38mm.

■ Rebate kits for both French Door and Bull Nose profiles are also available on request.

■ For double glazed doors, or doors over 45mm a 5 pin Euro cylinder can be used.

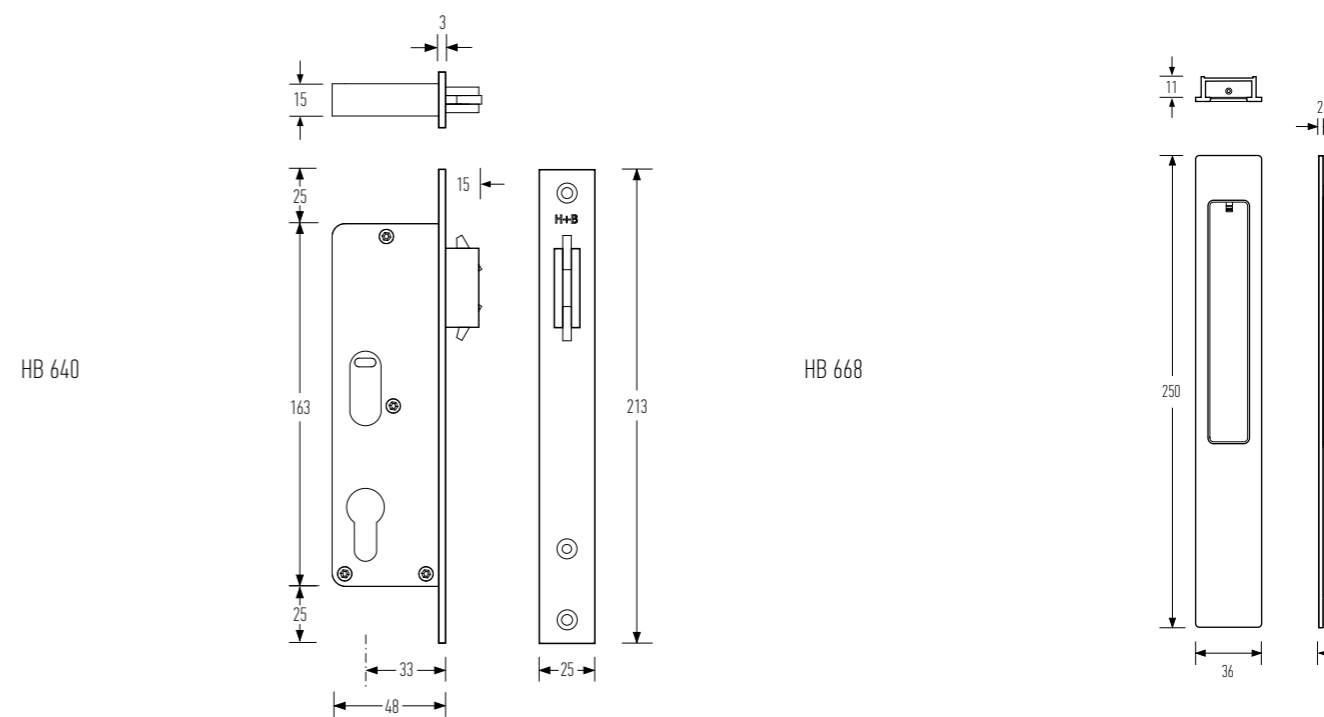

The HB640 Series allows for Euro cylinder key locking with a range of versatile flush pull options ideal for slimline aluminum joinery.

Designed and manufactured in New Zealand



HB 640



HB 642



HB 643



HB 648



HB 649



HB 649/2

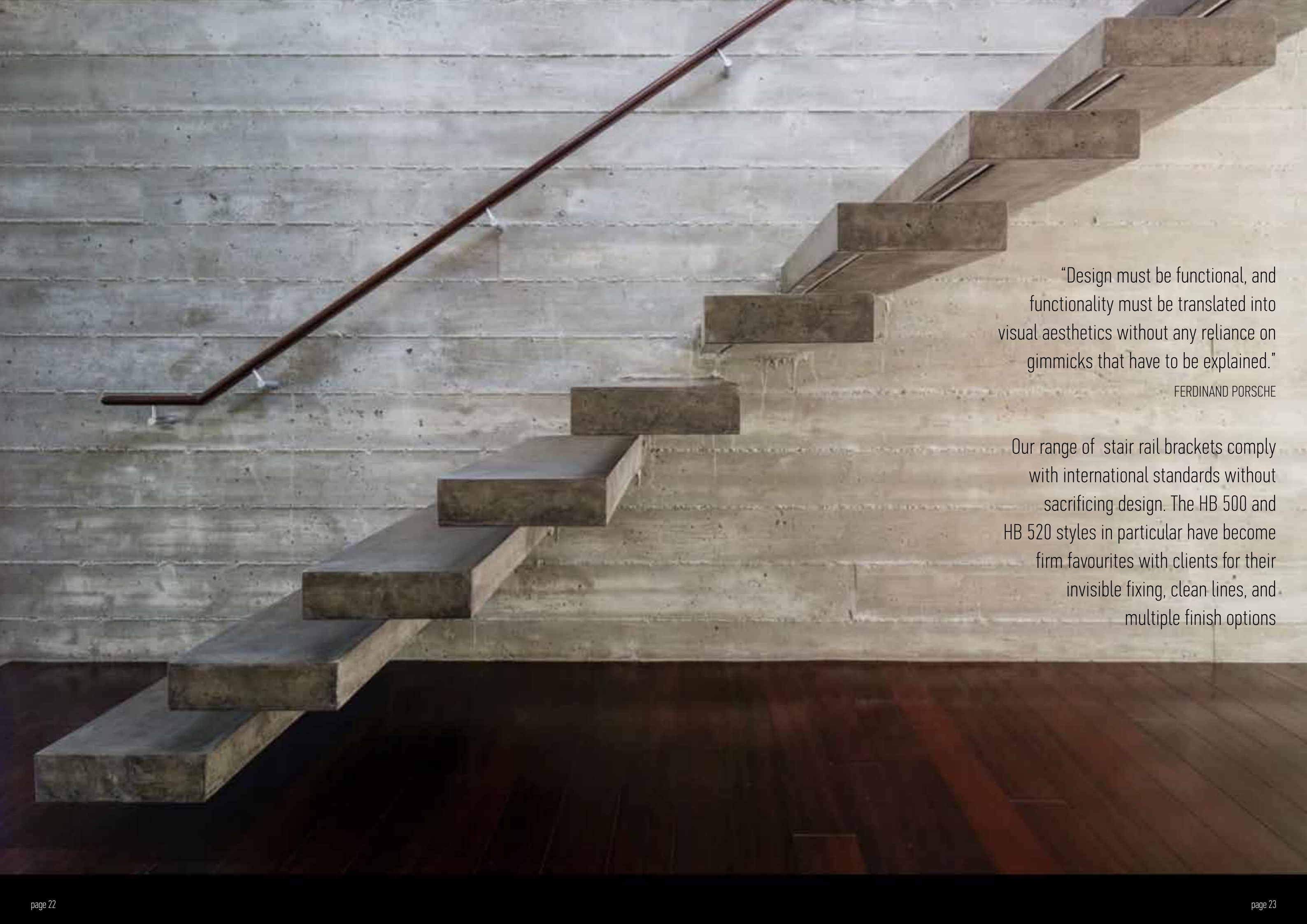

“Design must be functional, and functionality must be translated into visual aesthetics without any reliance on gimmicks that have to be explained.”

FERDINAND PORSCHE

Our range of stair rail brackets comply with international standards without sacrificing design. The HB 500 and HB 520 styles in particular have become firm favourites with clients for their invisible fixing, clean lines, and multiple finish options

STAIR RAIL BRACKETS

With health and safety in the home and workplace top of mind, the fixing of Halliday + Baillie stair rail brackets requires a wall bolt to be epoxied into a stud or to masonry for maximum resistance.

In accordance with both the AS/NZS 1170.1:2002 (Structural Design Actions) standards and the International Building Code, IBC (2003), the fixing of our various styles of brackets has been tested to failure well above approved limits making sure that if you fall on the stairs, your rail won't fall with you.

For superior durability several styles are also available in 316 marine grade stainless steel (HB510 and HB530 included), and can be used both indoor and out.



STAIR RAIL BRACKETS ALUMINUM, MARINE GRADE 316 STAINLESS STEEL & SOLID BRONZE

MODEL	DESCRIPTION	FINISH
HB 500	"T" Stair Rail Bracket Aluminum	Satin Chrome, other finishes to order
HB 502	Glass Fixing Kit for HB 500, in Aluminum	Satin Chrome, other finishes to order
HB 510	"T" Stair Rail Bracket cast in Solid 316 Stainless Steel (finish is matt not brushed)	316 Stainless Steel only
HB 512	Glass Fixing Kit for HB 510	316 Stainless Steel only
HB 520	Round Stair Rail Bracket, in Aluminum	Satin Chrome, other finishes to order
HB 522	Glass Fixing Kit for HB 520	Satin Chrome, other finishes to order
HB 530	Round Stair Rail Bracket milled in Solid 316 Stainless Steel	316 Stainless Steel only
HB 533	Glass Fixing Kit for HB 530	316 Stainless Steel only

■ Glass Fixing Kits are sold separately and are additional to the stair rail bracket.

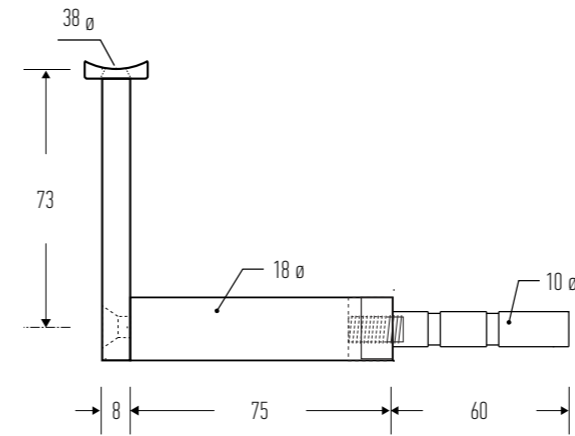

HB 500/ HB 510
(with M6 wall bolt fitting)

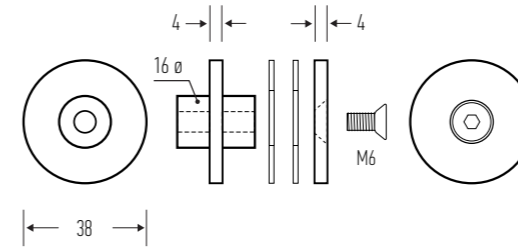

HB 502

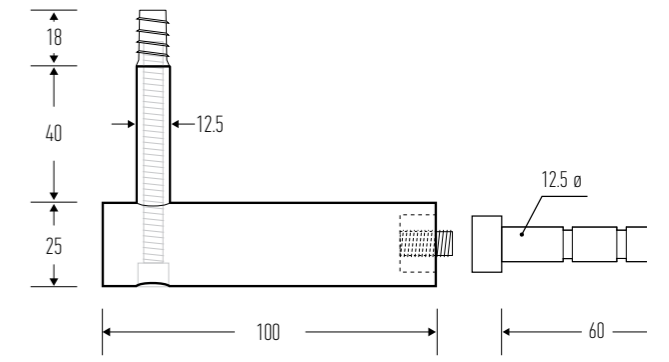

HB 520/ HB 530
(with M8 wall bolt fitting)

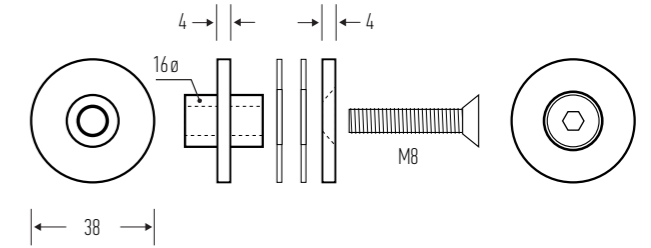

HB 522/ HB 533

While the HB500 and HB520 styles above are the icons of the Halliday + Baillie bracket range, there is a wide variety to choose from as below.

Designed and manufactured in New Zealand



HB 500 HB 502 with HB 500 HB 510 HB 512 with HB 510 HB 520 HB 522 with HB 520 HB 525 HB 526 HB 527 HB 528



HB 530 HB 533 with HB 530 HB 540 HB 542 with HB 540 HB 560 HB 570 HB 580 HB 590 HB 595



Classics become classics for a reason
— our range of solid Brass D Pulls
encompass both the familiar, and a twist
on the original. Available in several sizes,
pulls come in both the recognisable
tubular shape or with a contemporary
square edge and will continue to look
great year after year.



PULLS

MODEL	DESCRIPTION	FINISH
HB 2230	Round D Pull 300mm Long 16mm Rod	AB, PB, SB, KC
HB 2235	Round D Pull 300mm Long 19mm Rod	AB, PB, SB, KC
HB 2240	Round D Pull 600mm Long 19mm Rod	AB, PB, SB, KC
HB 2245	Round D Pull 600mm Long 16mm Rod	AB, PB, SB, KC
HB 2250	Round D Pull 1200mm Long 19mm Rod	AB, PB, SB, KC
HB 2260	Round Single Knob for 19mm Knob	AB, PB, SB, KC
HB 2265	Round Single Knob for 16mm Knob	AB, PB, SB, KC
HB 2237	Offset D Pull 300mm Long 19mm Rod	AB, PB, SB, KC
HB 2247	Offset D Pull 600mm Long 19mm Rod	AB, PB, SB, KC
HB 2330	Square D Pull 300mm Long 19mm Bar	AB, PB, SB, KC
HB 2340	Square D Pull 600mm Long 19mm Bar	AB, PB, SB, KC

- Pulls sold individually (not as pairs).
- Custom colours available for bulk orders – please contact your local Halliday + Baillie representative.
- Compatible locking options for sliding and swing doors are available.

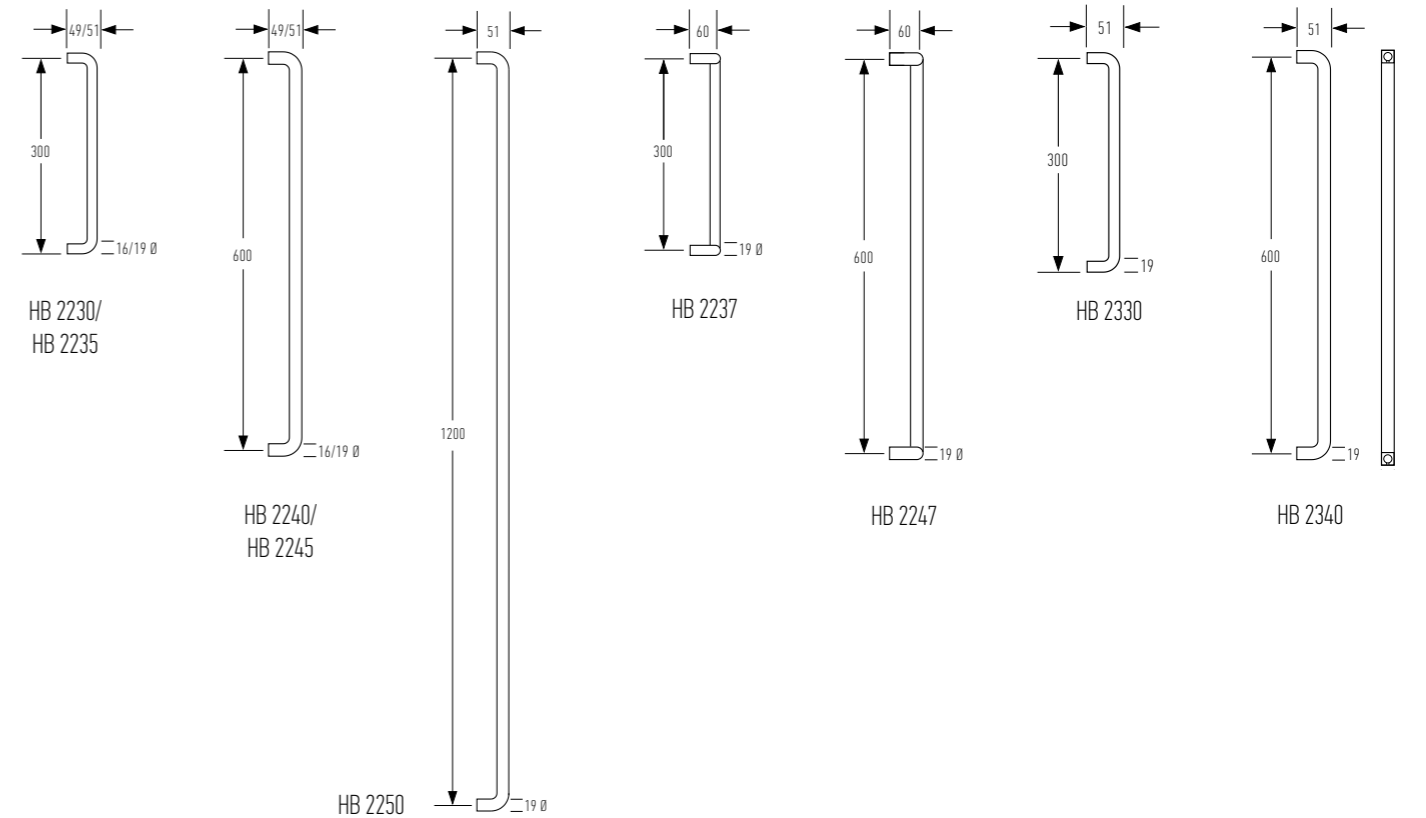

Designed and manufactured in New Zealand

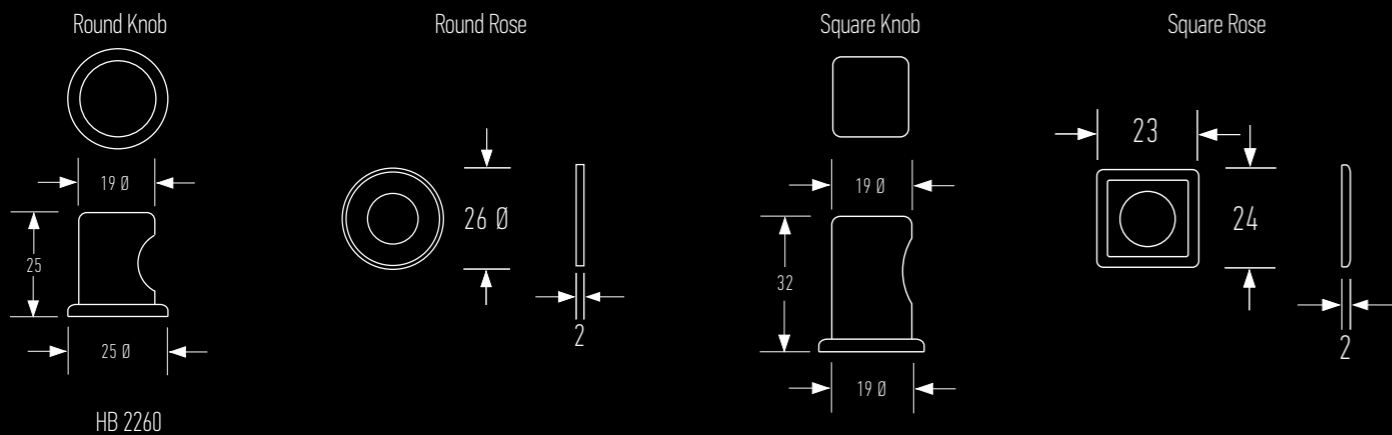

All knobs can be installed with or without the brass rose.





FIXING SETS

MODEL	DESCRIPTION	FINISH
HB 2220 16mm BtB	Back to Back Kit, HB2200 Series 16mm Rod	AB, PB, SB, KC
HB 2220 19mm BtB	Back to Back Kit, HB2200 Series 19mm Rod	AB, PB, SB, KC
HB 2220 16mm Face	Face Fix Kit, HB2200 Series 16mm Rod	AB, PB, SB, KC
HB 2220 19mm Face	Face Fix Kit, HB2200 Series 19mm Rod	AB, PB, SB, KC
HB 2220 16mm AFace	Aluminum Face Fix Kit, HB2200 Series 16mm Rod	AB, PB, SB, KC
HB 2220 19mm AFace	Aluminum Face Fix Kit, HB2200 Series 19mm Rod	AB, PB, SB, KC
HB 2220 16mm Glass	Glass Fix Kit, HB2200 Series 16mm Rod	AB, PB, SB, KC
HB 2220 19mm Glass	Glass Fix Kit, HB2200 Series 19mm Rod	AB, PB, SB, KC
HB 2220 16mm GBtB	Glass Back to Back Fix Kit, HB2200 Series 16mm Rod	AB, PB, SB, KC
HB 2220 19mm GBtB	Glass Back to Back Fix Kit, HB2200 Series 19mm Rod	AB, PB, SB, KC
HB 2220 16mm TF	Through Fix Kit, HB2200 Series 16mm Rod	AB, PB, SB, KC
HB 2220 19mm TF	Through Fix Kit, HB2200 Series 19mm Rod	AB, PB, SB, KC

- Fixing sets sold separately to allow for a variety of door types and configurations.
- Fixing sets sold in matching finishes made from solid brass and 316 marine grade Stainless Steel.
- Ships with matching roses – handles can be installed with or without the rose, but roses are recommended for use with soft woods, and on longer length pulls.

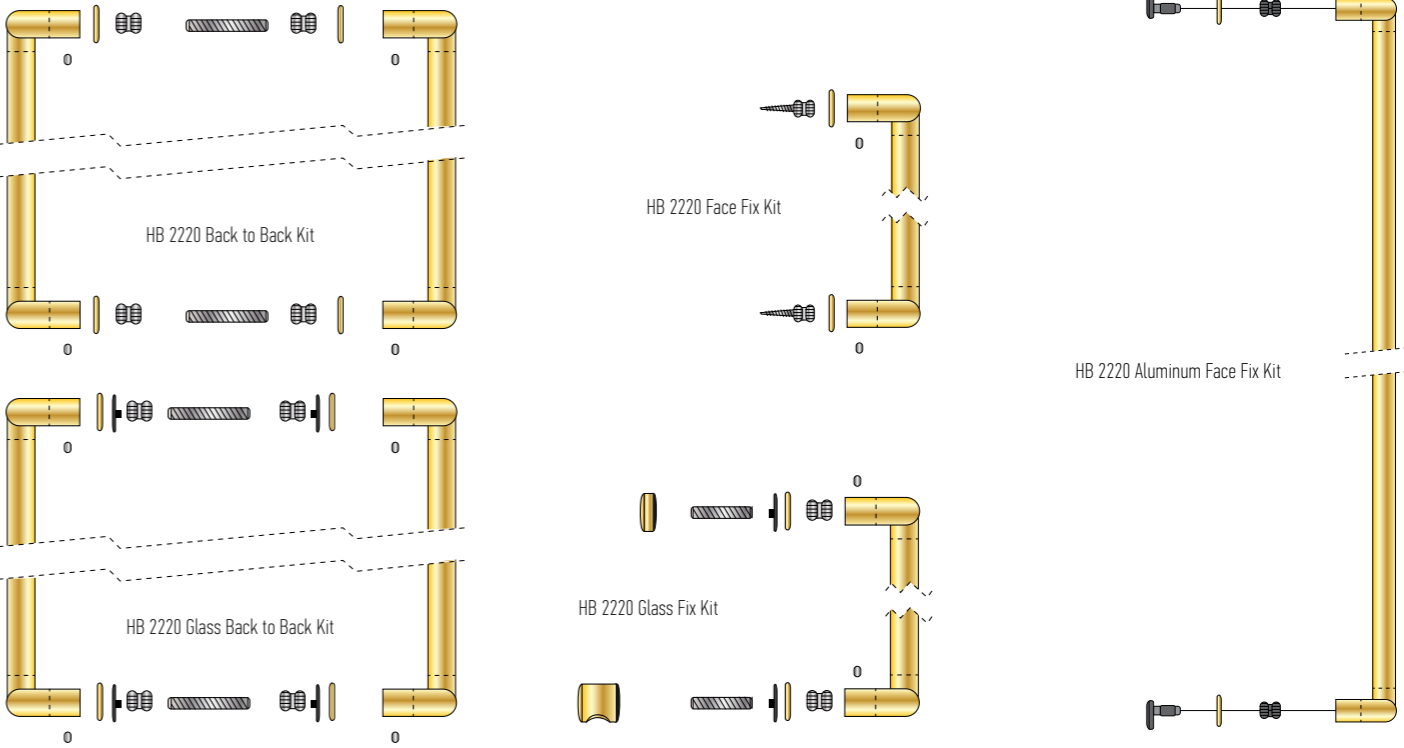

Designed and manufactured in New Zealand

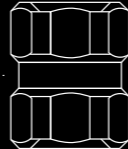

Adaptor



Hanger bolt

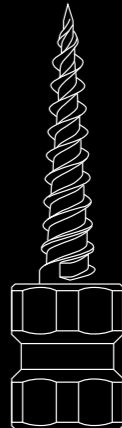

Adaptor screw

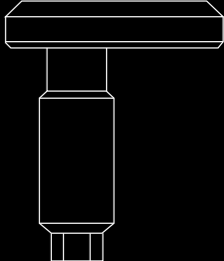

Aluminum fix

PASSIONATE ABOUT MANUFACTURING

Over the two decades that Halliday + Baillie have been making hardware, the passion for making great products, for great projects, using the best people, has never waned.

All our products are designed and manufactured in New Zealand, which is something we've been able to achieve by working closely with our New Zealand manufacturing partners.

As we have grown, increased scale has allowed efficiencies in the production of our products. Constant evaluation and innovation around processes, raw materials, and sustainable work practices, has led to the development of more effective production techniques, less waste, and new products across the range. The determination to keep 'doing it better' underpins everything we do.

In New Zealand we "kiwis" have a phrase about having a Number 8 Wire mentality. Wikipedia describes it as "the wire [a standard gauge, easily found, fencing material] would often be used inventively and practically to solve mechanical or structural problems other than fencing. Accordingly, the term "number 8 wire" came to represent the ingenuity and resourcefulness of New Zealanders..."

At Halliday + Baillie it is more than just a 'make do and mend' ideal. What Wikipedia doesn't cover is the inventive drive involved with this resourcefulness, and the fundamental thinking that questions not only how existing items could be utilised differently, but how we view the designed world around us. This adaptive reuse has morphed into an experimental way of working that allows for some of the world's great innovations born of isolation and limited resources.

This innovation process is embedded in both New Zealand's and in Halliday + Baillie's identity.

This kind of thinking really comes into its own in times of crisis. The year 2020 has changed so much around the world, and has encouraged us at Halliday + Baillie to make fundamental changes to how we work. These will not be temporary. When the global community tips on its head and all established conditions have changed, you can either hang on to what you know, or use the change to reach for something new. Far from limiting our work, the range of options only grows.

The ability to pick ourselves up and get back to doing what we do quickly and decisively is crucial, and it's that "number 8" attitude that will allow us to change and adapt to whatever the new normal brings.

We can do this.

We can find positivity in adversity.

We can 'build a better mousetrap' (or sliding lock as the case may be).

We can work with our wonderful, dedicated, community of people over the phone, over the internet, or by yelling over the road if necessary and still get great products made to grace more great projects around the world!

We're looking forward to working with you.

Halliday + Baillie – creating classics

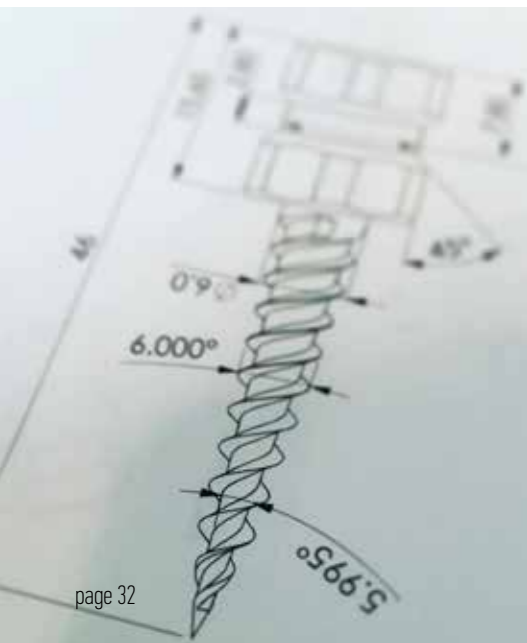

ELECTROPLATED

Electroplating is done by passing an electric current through a chemical solution that contains various metals plus the objects being plated. The current causes the metal in the solution to be attracted to the object and bond with it. The finishes listed all have several layers and processes of plating, and can be bonded to a variety of base metals including steel, stainless steel, brass, copper, zinc and aluminum.

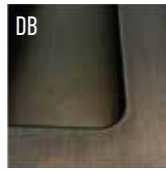

BN : Brushed Nickel. Our brushed nickel finish undergoes several stages for a classic finish and superior durability. As with most of our zinc hardware, a base of several copper layers are plated first followed by a two-step nickel process. The first layer is a bright sulphur free nickel for corrosion resistance. This is followed by a second pearl bright satin nickel layer to achieve our characteristic velvet look. When the two layers are present a higher corrosion resistance is achieved than just the semi-bright layer on its own. After coating the items are brushed for a finish which is a match to most satin or brushed stainless steel items.

DB : Dark Bronze. To achieve this finish several copper layers are plated, followed by a thick satin nickel later to achieve the robust thickness suitable for a patina. Following the first stages a thick layer of heavy brass is electrodeposited on the article which is then brushed to produce an even appearance as above. A special aging solution is then used to simulate a natural antique 'aged' look. The surface is then wiped with wax. This process is considered a 'living finish' and will patina over time and with different weather conditions. This is not considered a flaw in the process but rather, a desirable characteristic of the continuous aging process of this material. Exact colour matching is not possible between batches.

KC : Matt Black Chrome. To achieve our soft flat black, items are plated to the same level as our "Brushed Nickel" but without the brushing stage. Items undergo an additional plating step in a black chrome bath which gives added protection and a deep black finish, before being hand waxed to provide surface consistency and to minimise finger printing on the surface when new. Please note that the wax on these items will gracefully wear away over time.

PB : Polished Brass (unlacquered). To achieve this finish a thick layer of brass is electrodeposited on the article after the same multiple copper and nickel plating process is undertaken as with our Brushed Nickel. These additional layers provide heightened durability and protect the base metal. After brass plating, items are brushed to a high polish. On dispatch items are a bright mirror brass without further coating or lacquer, and are considered a 'living finish'. The surface of items will dull and patina over time and with different weather conditions if not kept polished. This is considered a desirable characteristic in the aging process of unlacquered brass.

PC : Polished Chrome. Our bright/polished chrome finish undergoes the nickel process as detailed in "Brushed Nickel". After the polishing step, articles are plated with a heavy chrome barrier layer, and finally polished to a high mirror shine.

SC : Satin Chrome. To achieve this finish a special pearl bright satin nickel plating process is used. Additives to the twin nickel layers cause the plating process to produce a velvet/satin result that is then over-plated with heavy chrome. This smooth velvet finish is ideal for both interior and exterior use, where superior durability is required.

POWDER COATED

The standard Halliday + Baillie powder coat colours are applied electrostatically, then cured under highly controlled temperatures to allow it to form a robust 'skin'. Powders can be thermoplastic or thermoset polymer and are used to create a hard finish that is tougher than a conventional paint.

Unlike anodised or electroplated finishes Electro™ powder coatings can be applied to an even wider variety of substrates. Electro™ finishes are highly durable and made from UV resistant materials with no liquid chemicals, solvents or caustic solutions used in their manufacture. The Electro™ powder coatings also have a negligible VOC content and are suitable for a range of climatic conditions, from hot to cold and humid to dry. Importantly the Electro™ range has excellent colour retention and is suitable for use in projects further than 10 metres from salt water making it a superior choice for coastal environments.

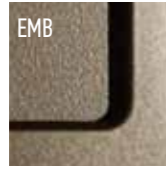
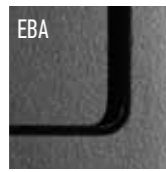

EBA : Electro Black Ace. This finish has one of the lowest gloss levels we have seen in a powder coat. Along with its opposite Electro Flat White, this finish has a matt appearance, ideal for subtly blending into dark cabinetry or doors.

EDB : Electro Dark Bronze. This finish has a pearlescent or metallic content rather than a standard flat paint finish, providing a more 'metal' look than standard powder coats. The Electro Dark Bronze is also a good alternative to full black where a slightly softer approach is required.

EMB : Electro Medium Bronze. Like the darker finish above, the Medium Bronze has a pearlescent or metallic finish that sets it apart from standard flat paint powder colours. The lighter tone of this finish matches more closely to traditional aged brass finishes, without the issues of colour matching between batches, or the changing patina inherent in living finishes. This is a great option where the look of bronze is required, but not the variability of colour.

EFW : Electro Flat White. This is the most matt of all the powder coated finishes, and has a soft matt texture. While we do keep small stocks of product in Electro Flat White additional lead times may apply for this finish.

WHT : Appliance White. A good match to RAL 9016 Traffic White, this finish has a higher gloss level than our other powder coated finishes, and true to the traditional powder coat look.



SOLID BRASS (D Pull Series Only)

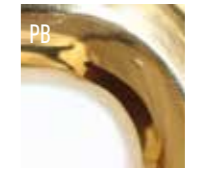

All of our D Pull range is bent or milled from solid brass bar for optimum quality and to ensure elegant aging over time. Our brass is sourced in New Zealand and is RoHS certified to meet international standards. All of our D Pulls are shipped without any additional coatings or lacquer. With the exception of the Black Chrome, all pulls are therefore a "living finish" and will age and patina over time.

AB : Aged Brass. To get the traditional look (often called 'Tuscan Brass'), solid brass bars undergo an oxidising process to give a darkened look which is then hand burnished and waxed to seal the finish. Please note that the wax on these items will gracefully wear away over time as the handle patinas.

PB : Polished Brass. After bending and/or milling, handles are hand polished to a mirror finish. On dispatch this finish is a bright mirror brass without further coating or lacquer, and is considered a 'living finish'. The surface will dull and patina over time and with different weather conditions if not kept polished which is considered a desirable characteristic in the aging process of brass.

SB : Satin Brass. After bending and/or milling, handles are given a light hand polish to remove any surface inconsistencies, then hand sateened to give a soft lustre. As with the Polished Brass pulls, this is a 'living finish', and the surface will dull and patina over time and with different weather conditions if not kept polished. This is considered a desirable characteristic in the aging process of brass.

KC : Black Chrome. Similar to the standard black chrome the brass is double coppered, followed by a fine layer of bright nickel and a layer of satin nickel before brass plating. An additional plating step in a black chrome bath gives added protection and a deep black finish, before being hand waxed to provide surface consistency and to minimise finger printing on the surface when new. Please note that the wax on these items will gracefully wear away over time.

BULK ONLY



These finishes are available in minimum quantities only. Please contact your local Halliday + Baillie representative for further information.



BSC : Brushed Satin Chrome. To achieve this finish a special pearl bright satin nickel plating process is used as per the standard Satin Chrome finishes including the twin nickel layers. The resulting velvet/satin result is then over-plated with heavy chrome and finely brushed before assembly. This finish is only available for orders of 30 or more of the same product.

PN : Polished Nickel. Our bright/polished nickel finish undergoes the same process as detailed in "Brushed Nickel". After coating however, the items are polished to a high shine mirror finish rather than brushing. This finish is only available for orders of 30 or more of the same product.

OTHER — STAIR BRACKETS

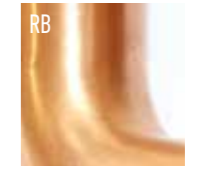

Our wide range of brackets are made from aluminum, 316 stainless steel, and raw gunmetal bronze. Please note that the HB 510 is a bead blasted stainless steel finish, and the HB 526, HB 528, and HB 530 are all milled stainless steel (more of a match to brushed stainless steel). All aluminum brackets come in Satin Chrome as standard. The following brackets can also be coloured with most of our Electroplated and Powder Coated finishes – HB500, HB520, HB525, HB527, HB540 and HB595. The HB550, HB560, and HB570 styles can be coloured to SC only. All finishes other than SC, BS/SS, CS and RB are done to order and may have additional lead times.

SC : Satin Chrome. Although plated onto a solid milled aluminum base rather than on zinc, this finish is achieved with the same special pearl bright satin nickel plating process as the standard Satin Chrome on our flush pulls and lock sets. Additives to the twin nickel layers cause the plating process to produce a velvet/satin result that is then over-plated with heavy chrome. All brackets are available in this finish as standard.

SS : Brushed Stainless Steel. This is a mill finish on 316 marine grade stainless steel and is available on the HB526, HB528, and HB530 brackets only. After precision CNC cutting, the surface is finely brushed to give the characteristic stainless steel sheen. These brackets are ideal for use outside, and where additional durability is required.

CS : Cast Stainless Steel. Unlike our other 316 marine grade stainless steel brackets, the HB510 is cast rather than milled. After casting, the components are bead blasted to give a textured industrial feel. This bracket is also ideal for use outside and where a additional durability and a tough aesthetic is needed.

RB : Raw Bronze. After precision CNC cutting from blocks of solid bronze, the surface is very finely brushed. This is a 'living finish' and the surface will dull and patina over time and with different weather conditions if not kept polished. Given the high copper content of bronze, in exterior situations these brackets may attain the Verdigris look common to aged copper. This is not considered a fault but rather a desirable characteristic of this material.

■ Please check with your local Halliday + Baillie representative as not all finishes are available in all regions. Halliday + Baillie sliding door hardware is available in the following durable high-quality finishes.

CREATING CLASSICS

NEW ZEALAND SHOWROOM:

1:5 Axis Bldg, 91 St Georges Bay Road, Parnell, Auckland
Phone: +64 9 358 1172 | Fax: +64 9 358 1176
Email: sales@hallidaybaillie.com

AUSTRALIAN SHOWROOMS:

Sydney: Ground Floor, 45 Chippen Street, Chippendale, NSW
Phone: +61 2 9699 3330
Email: sales@hallidayandbaillie.com

Melbourne: 440 High Street, Prahan, VIC 3181
Phone: +61 427 225 174
Email: sales@hallidayandbaillie.com
Open by prior appointment

DISTRIBUTED IN NORTH AMERICA:

Bridgeport Worldwide, LLC: 34 Norman Street, CT06605
Phone: +1 800 362 1484
Email: info@bridgeportworldwide.com
www.bridgeportworldwide.com

DISTRIBUTED IN UNITED KINGDOM:

Opitome Ltd: The Busworks, 39-41 North Road, London
Phone: +44 7 889 536 911
Email: curious@opitome.co.uk
www.opitome.co.uk

DISTRIBUTED IN ASIA:

asia@hallidayandbaillie.com

DISTRIBUTED IN MIDDLE EAST:

middleeast@hallidayandbaillie.com

DISTRIBUTED IN EUROPE:

europe@hallidayandbaillie.com



All products in this catalogue are 100% designed and manufactured in New Zealand using quality raw materials that comply with all ethical guidelines.

For further information, technical sheets, templates etc for the products shown, please visit www.hallidaybaillie.com or contact your local Halliday + Baillie dealer.

© Products and Design, Halliday + Baillie, 2021

hallidaybaillie.com