

**halliday
baillie**

HB 1650 SERIES

OFFSET GRIP DOOR SERIES – 55mm BACKSET

The HB1650 Offset Pull Door Set is a mid-sized series for use on sliding doors where scale is required, or the doors are heavy. The matching HB 1650 D series can be specified for oversized swing and pivot doors for extra purchase, and in a bi-fold situation.

Sets utilize the longer HB 677 flush pulls which offer a deeper internal finger area and an offset grip to one side resulting in left and right-handed options. Please indicate whether a left or right-handed snib flush pull is required for order.

Flush Pull Material : Diecast Zinc and Brass

Lock Body Material : Diecast Zinc, Brass, 316 Stainless Steel

Backset : 55mm

Minimum door thickness : 45mm

Flush pulls : 250 x 46 x 17

Internal grip depth : 15mm

Suitable for timber or large profile aluminium doors.

Standard HB 1650 set includes :

- HB 690 Series Lock Body
- Two HB 677 Flush Pulls
- HB 604 Timber Fixing Kits (one for HB 1653 sets)
- Strike and Dust Box
- Two spindle lengths (please specify door thickness for doors over 60mm)
- Fasteners

Configurations :

HB 1650 : Privacy Set, Snib Inside, ER Indicator Outside

HB 1652 : Snib Inside, Blank Outside

HB 1653 : Snib Inside, No Pull Outside

HB 1654 : Snib Both Sides (passage latch)

Available in all standard Halliday + Baillie finishes, see finishes sheet for further details.

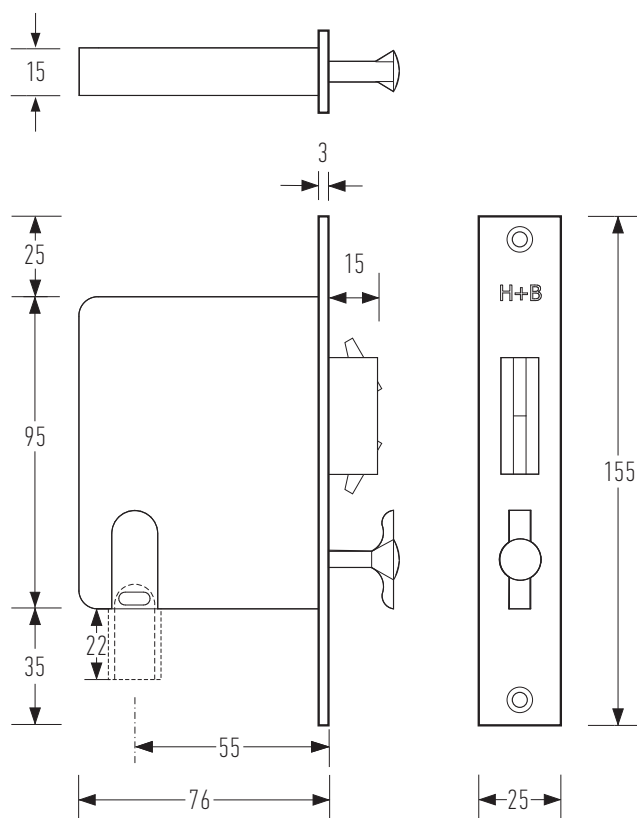

Designed and manufactured in New Zealand. For more information, installation templates, and measured drawings of this product and others please visit : www.hallidaybaillie.com or contact your authorized Halliday + Baillie dealer. All information subject to change.

© 2021 v1 Halliday + Baillie Ltd.

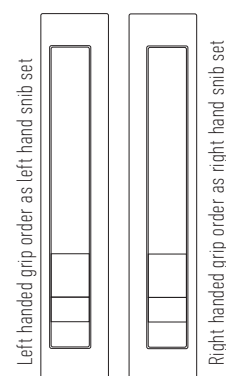

To be used with HB604 Timber Fixing Kit on timber doors



dustbox and strike plate

Please note the handing of the snib flush pull denotes the handing of the set.