

HB 604 TIMBER FIXING KIT

The HB 604 allows various Halliday + Baillie flush pulls to be installed into timber joinery with concealed fixing.

Most of our flush pull handle range are designed to go straight into aluminium or steel joinery without the use of these kits.

For each flush pull you require 1 x HB 604 Timber Fixing Kit. All flush pulls ship with the timber fixing kit.

Flush Pulls using HB 604:

HB 650
HB 660
HB 660/35
HB 665
HB 668
HB 670
HB 675
HB 677
HB 678
HB 679
HB 3370
HB 3375

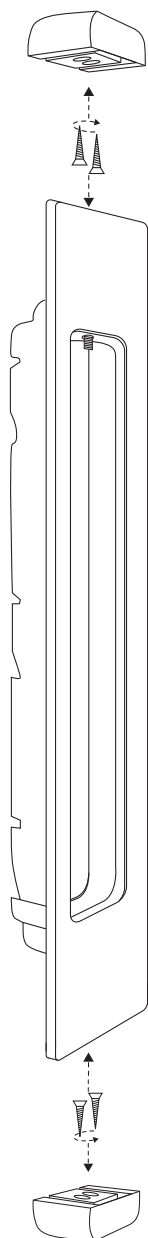

Screw fixing kits shown for timber

HB 604 Timber Fixing Kit on timber doors

