

**halliday
baillie**

HB 697 SERIES BODY & END PULL ONLY

The HB 697 sliding door full body keeper with integrated end pull for bi-parting sliding doors matches the dimensions of the HB690 privacy lock body.

The keeper body is used in place of the standard strike and dust box for pocketed bi-parting doors where an HB 690 lock set is used to hold the two doors together. The advantage of the HB 697 over a standard strike plate is to allow for a matching push button pop out with the same face dimensions as the opposing lock set.

Please note: the HB 697 will match the lock body for the following sets only :

- HB 690 Series
- HB 695 Series
- HB 1480 / HB 1480D Series
- HB 1490 Series
- HB 1650 / HB 1650D Series

The passive leaf can be paired with the matching privacy set blank flush pulls.

Standard HB 697 includes : Keeper body with end pull only.

Flush Pull Material : Diecast Zinc and Brass
 Minimum door thickness : To match active leaf set
 Flush pulls : To match active leaf set
 Internal grip depth : To match active leaf set

Suitable for timber or wide profile aluminium doors,

Available in all standard Halliday + Baillie finishes, see finishes sheet for further details.



Shown with HB 660 Flush Pull
(ordered seperately)

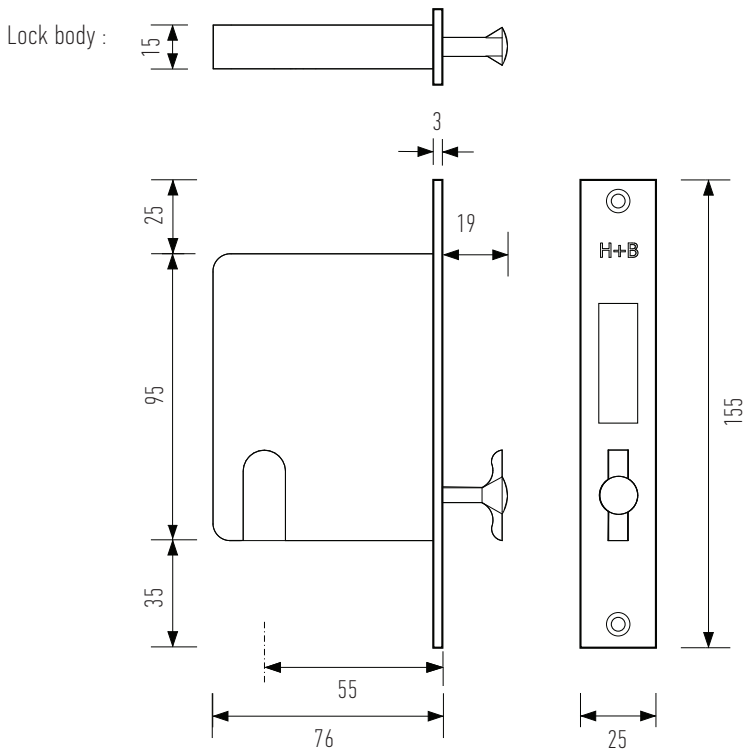

Designed and manufactured in New Zealand. For more information on this product and others please visit www.hallidaybaillie.com. For dealers in North America, contact Bridgeport Worldwide +1-800-362-1484 www.BridgeportWorldwide.com/hallidaybaillie. All information subject to change.